

SARS-CoV-2/Flu A+B/HPIV2/HPIV1+3/RSV/ADV/MP Antigen Rapid Test Kit (Immunochromatographic Assay)

BioTeke
USER INSTRUCTION



1. Read this instruction guide carefully.
2. Have ready a watch (or a clock/timer), tissues and either hand sanitizer or soap and warm water.
3. Check the test kit contents to make sure that nothing is damaged or broken.

-For oropharyngeal swabs.

-Please read the instructions carefully before you begin testing.

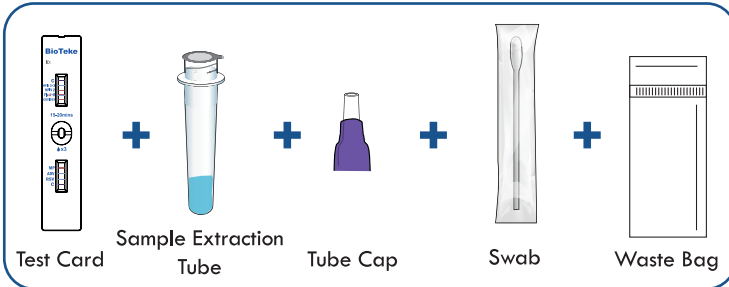

Note: Test cards kept at low temperature should be restored to room temperature before opening to avoid moisture absorption.

Note: Materials required but not provided.

- (1) Watch (or a clock/timer),
- (2) Tissues,
- (3) Hand sanitizer / soap.

1

Wash your hands thoroughly for at least 20 seconds before the test.



Peel off

2

Put the tube into the kit box holder and gently peel off the aluminum foil seal.

3

Either of the anterior nasal swab collection and the oropharyngeal swab collection can be chosen. Once the collection is complete, the later test steps are the same.

Remove the swab from its wrapper and take out the swab by holding the handle. Do not touch the fabric tip of the swab with your hands.

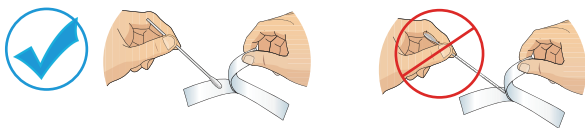

4 Oropharyngeal swabs collection:

Oropharyngeal swab collection: Insert the swab in the mouth completely into the pharynx, centering on the red swelling of the pharynx wall and upper anterior tonsils. Wipe both sides of pharyngeal tonsils and pharynx posterior wall with moderate force, avoid touching the tongue, and remove the swab.

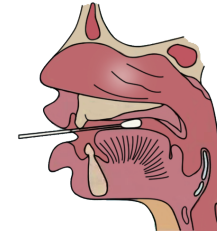

5

Insert the swab into the sample tube. Touch the bottom of the sample tube with the swab tip, and stir at least 5 times. Squeeze the swab in the tube through the outer wall of the tube by fingers 5 times.

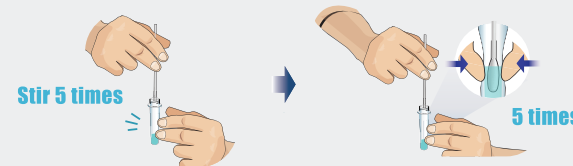

6

Remove the swab by rotating against the sample tube while squeezing the sides of the tube to release the liquid from the swab. Remove and discard the swab.

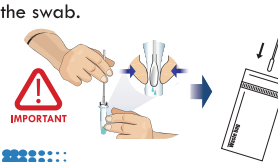

7

Screw the purple tube cap onto the sample tube and then unscrew the top white cap.

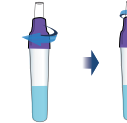

8

Open the pouch and take out the Test Card. Place it on a flat, dry and clean surface. Turn the tube integrated dropper cap upside down and vertically at 90 degrees, gently squeeze to slowly and evenly drip 3 or 4 drops of liquid from the dropper into the sample hole of the detection card.

(Note: Improper operation may cause too much or too little liquid to drip into the sample hole, which can affect the detection results.)

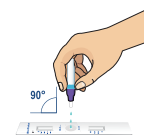

15-20 minutes

9 Results Interpretation



NOTE:

The test results should not be read after 30 minutes.



(Positive)

Two colored (C) lines appear in two separate windows. If the other line appears, the corresponding pathogen is positive.

Special Flu A+B with red color representing influenza A virus and blue color representing influenza B virus.

Note: A positive result means that you are likely to be infected with SARS-CoV-2/Influenza A virus/Influenza B virus / Human Parainfluenza virus 2/ Human Parainfluenza virus 1+3/ Respiratory syncytial virus/Adenovirus / Mycoplasma pneumoniae

Note: Test results should always be interpreted in the context of clinical observations and epidemiological data when making final diagnoses and patient management decisions.

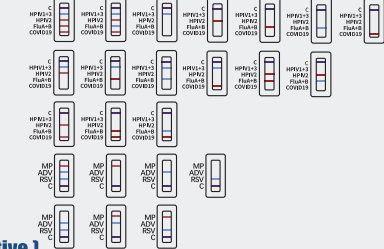

(Negative)

Two colored (C) lines appear in each window, and if no other lines appear, the corresponding pathogen is negative. However, a negative result does not exclude the absence of SARS-CoV-2/Influenza A virus/Influenza B virus / Human Parainfluenza virus 2/ Human Parainfluenza virus 1+3/ Respiratory syncytial virus/Adenovirus / Mycoplasma pneumoniae infection and should not be used as the sole basis for treatment or patient management decisions.

Negative results should be considered in the context of the individual's recent exposure history, medical history and the presence of clinical signs and symptoms consistent with SARS-CoV-2/Influenza A virus/Influenza B virus / Human Parainfluenza virus 2/ Human Parainfluenza virus 1+3/ Respiratory syncytial virus/Adenovirus / Mycoplasma pneumoniae and confirmed by nucleic acid testing as necessary for patient management.

(Invalid)

If any of the control (C) lines do not appear, the test must be interpreted as invalid.

An invalid test result means that your test has encountered an error and the results cannot be interpreted. You will need to retest using a new test card.

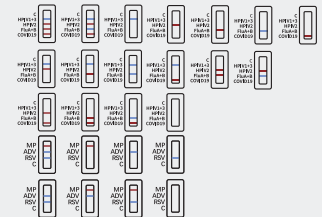

10

All used test components should be disposed of in your household waste. After completing all sampling and testing steps, wash hands or use hand sanitizer.





●Revision date: Dec.9, 2024

图纸名称	呼吸道八联检说明书- 英文	文件号	RD2114-15-04-001-A1	材质	双胶纸
尺寸	A4	颜色	见图纸		
设计/日期		审核/日期		批准/日期	